

HERE'S YOUR COPY OF

INSTANT BOSTON

A GUIDE TO THE METROPOLITAN AREA

Including . . .

- AREA HIGHWAY MAP
- MAP OF BOSTON PROPER
- PHOTO VIEWS OF ALL BOSTON
- MAJOR LANDMARKS
- MAP AND GUIDE TO PRUDENTIAL CENTER
- RESTAURANT GUIDE
- THUMBNAIL HISTORY OF BOSTON

prepared by BOSTON NOW magazine

PRESENTED AS A PUBLIC SERVICE BY YOUR PRUDENTIAL AGENT

INSTANT BOSTON IS NOT FOR SALE

Additional complimentary copies are available only through your Prudential Agent, one of 30,000 insurance professionals across the United States and Canada.

WHEN IS ENOUGH ENOUGH?

Ask your Prudential Agent. He's a specialist in helping you plan your financial future.

Published by BOSTON NOW and CAMPUS GUIDEPOST magazines... More than 725,000 copies distributed annually. For more info call 491-8034.

GREATER BOSTON AREA CITIES, TOWNS and HIGHWAYS

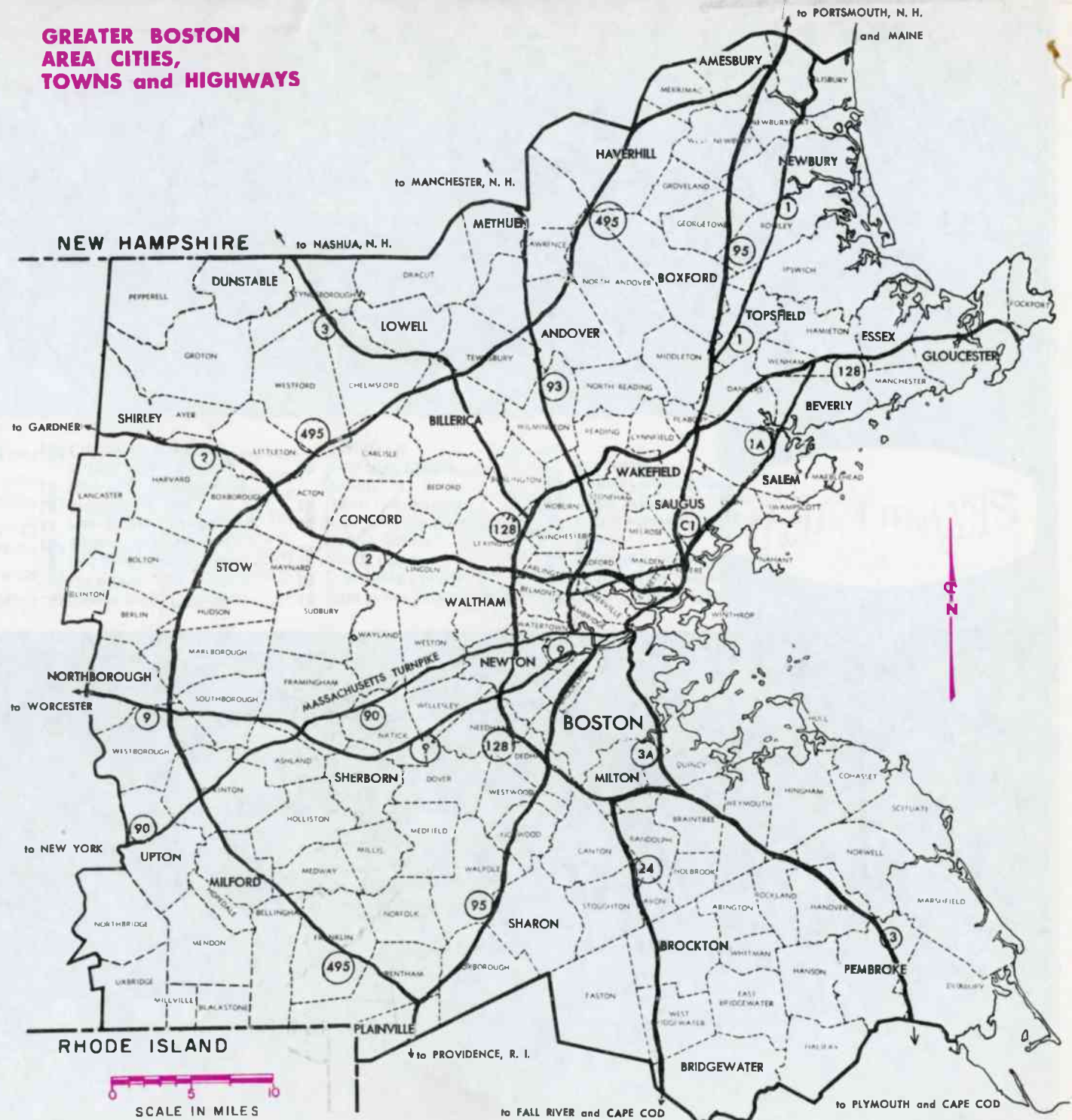

THUMBNAIL HISTORY

By the editorial staff of *BOSTON NOW* magazine

In 1630, ten years after the first Thanksgiving at Plymouth, 1,000 Puritans of the Massachusetts Bay Company settled near Charlestown and laid the foundations of a learned and prosperous city. America's first newspaper was founded here in 1704, the year Benjamin Franklin was born on Milk Street.

Soon religion and money were bones of contention with England. George III imposed the Stamp Act and levies on lead, tea, and paper to prove that Empire came first. Always Boston, hardest hit, protested loudest. A boycott on British goods led Britain to repeal the Stamp Act in 1766 but the next year she imposed more taxes, and troops cooled Boston's complaints. In 1770, an irate Bostonian threw a snowball at a soldier, began a famous melee. After "the Boston Massacre" four townsmen lay dead, and the colony seethed so that Britain felt advised to withdraw awhile.

Meantime, Sam Adams peopled committees of correspondence, Boston-based, to plan revolution. (1772).

And when Britain granted the East India Company a monopoly of the tea trade in 1773 cutting out American trade altogether the mob needed no persuasion to tip the company's tea into Boston Harbor's icy waters.

The Tea Party brought harsh retaliation from Britain — trials, restrictions, and occupation of Boston by Redcoats. In 1775 British troops set out to Concord to smash a rebel arms horde. Paul Revere rode from Cambridge to Lexington to warn the farmers; the marching British troops met resistance; and so the War of Independence was begun. Most famous of Boston's battles was the Battle of Bunker Hill, June 17, 1776.

Post-war Massachusetts drew up the nation's first Constitution on which the Federal one is based. As she grew to maturity the city grew prosperous and proper. She began the nation's first public schools in the third decade of the nineteenth century. She welcomed poets and philosophers, bred gentlemen and snobs. In the middle of the Victorian age, Boston led the debate against slavery. Harriet Beecher Stowe's "Uncle Tom's Cabin" was published here in 1852. Here, Louisa May Alcott dreamed of Meg, Jo, Beth and Amy. Hawthorne, Longfellow, Howells, Holmes, Emerson, Julia Ward Howe, Thoreau lived in the town's environs. The Massachusetts Institute of Technology was established in 1866. Boston built Public Gardens; a Fine Arts Museum, and Womens' colleges.

Like many cities Boston was host to Irish immigrants. This city is perhaps most identified with the Irish in America. Most famous of these sons, of course, are the Kennedys. 1918 — Brookline was the birthplace of John F. Kennedy.

Today Boston is in the throes of redevelopment. She is host to National Aeronautics and Space Administration Electronics Research Center in Cambridge; so helped put man on the moon. The inner city is being revamped so that much that was antiquated is modernized.

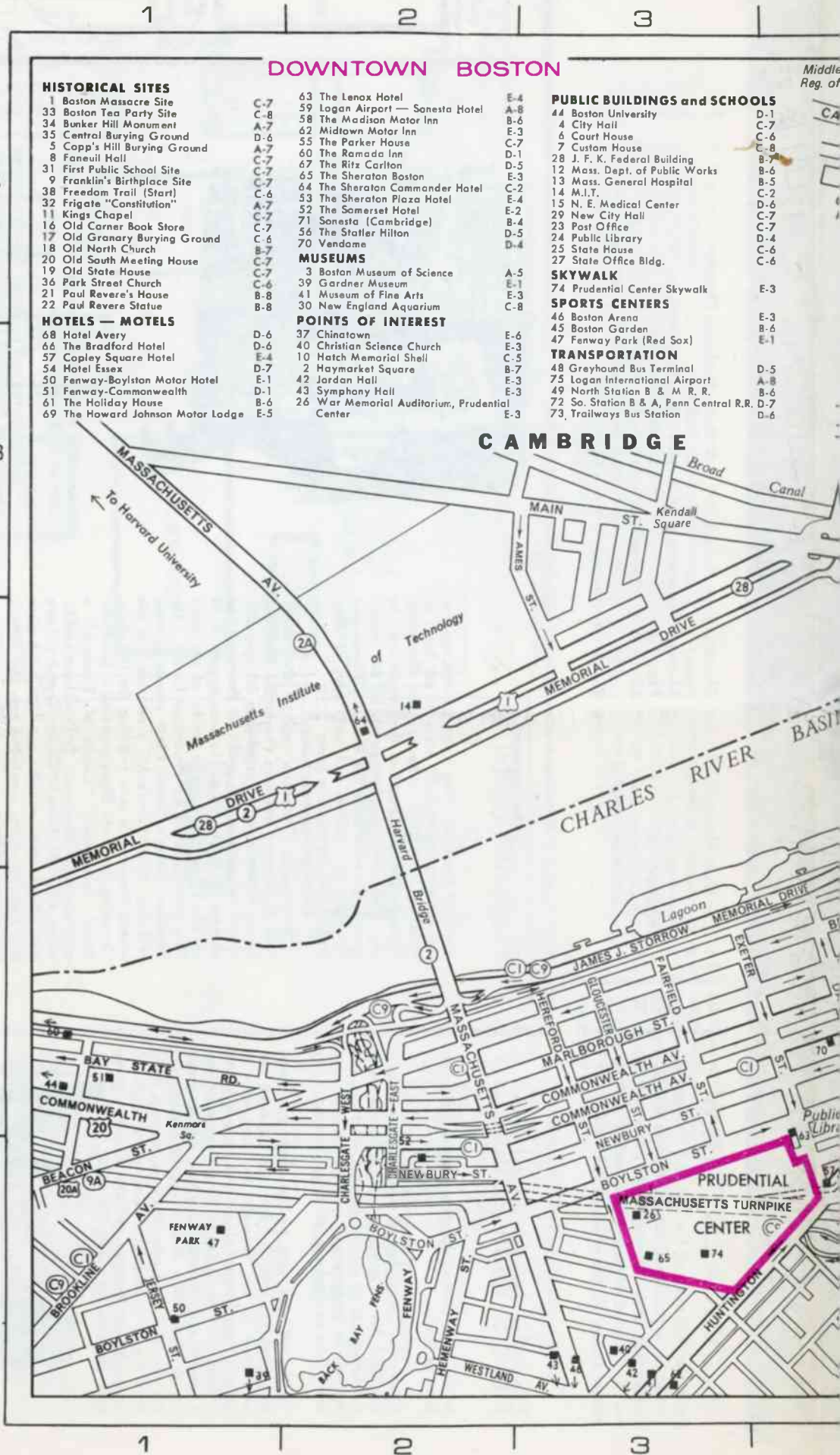

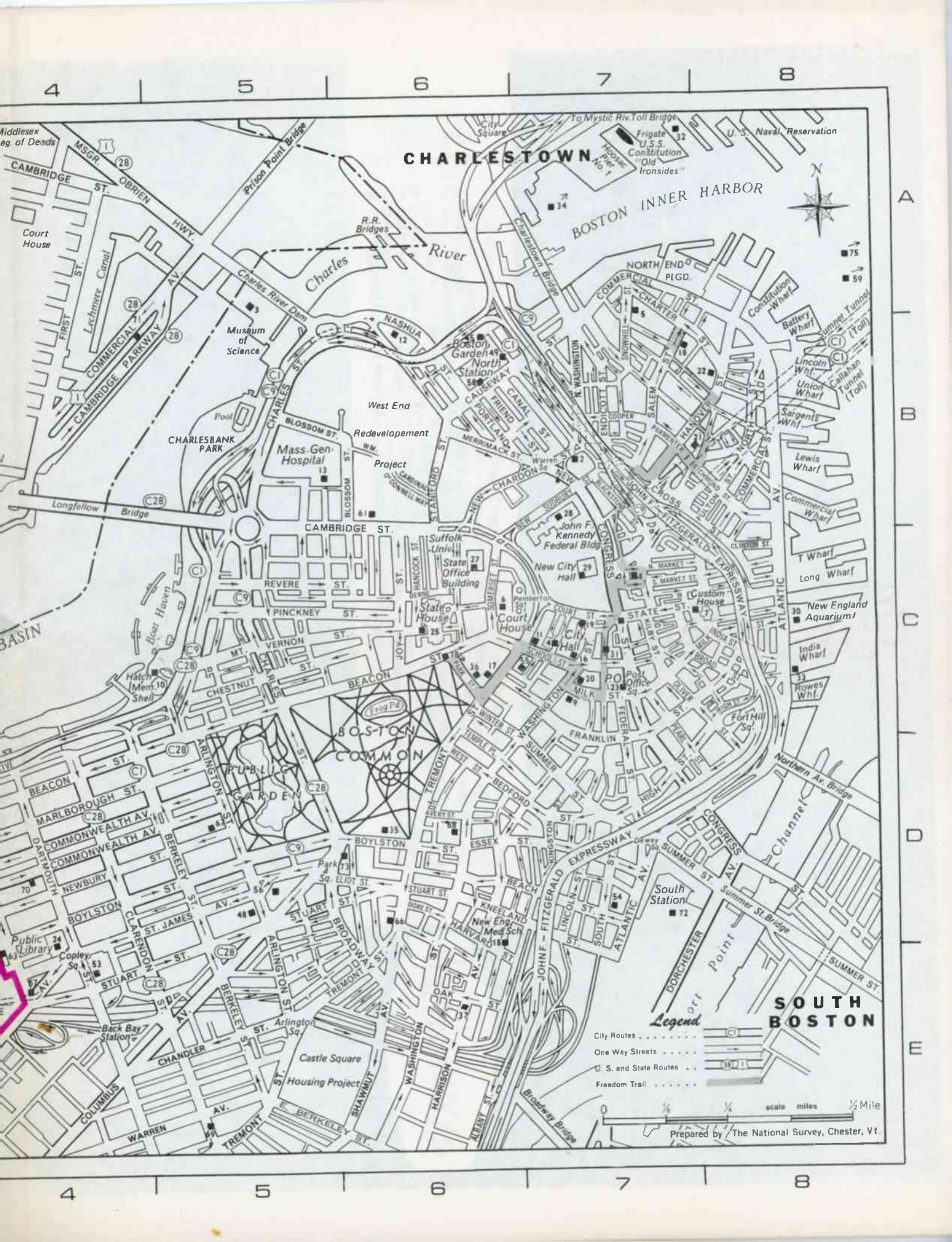

CHARLESTOWN

BOSTON INNER HARBOR



A

B

C

D

E

4 5 6 7 8

4 5 6 7 8

Middlesex
eg. of Deeds
CAMBRIDGE ST.
OBIEN HWY.
Lechmere Canal
FIRST ST.
COURT HOUSE
MUSEUM OF SCIENCE
CHARLES RIVER DAM
NASHUA ST.
BLOSSOM ST.
REVERE ST.
PINCKNEY ST.
VERNON ST.
CHESTNUT ST.
ARLINGTON ST.
BEACON ST.
MARLBOROUGH ST.
COMMONWEALTH AV.
NEWBURY ST.
BOYLSTON ST.
CLARENCE ST.
STUART ST.
CHANDLER ST.
WARREN ST.
TREMONT ST.
COLUMBUS ST.

Prison Point Bridge
Charles River
R.R. Bridges
Charles River Dam
West End
Redevelopment Project
Mass Gen Hospital
Suffolk Univ.
State Office Building
State House
Public Garden
Boston Common
Castle Square
Housing Project
Arlington Sq.
Shawmut St.
E Berkeley St.

City Square
Frigate U.S.S. Constitution "Old Ironsides"
NORTH END PLGD
COMMERCIAL ST.
CHARTER ST.
FRIEND ST.
PORTLAND ST.
MERRIMACK ST.
NEW CHURCH ST.
NEW SUPPLY ST.
NEW WASHINGTON ST.
CONGRESS ST.
COURT ST.
SCHOOL ST.
MILK ST.
FRANKLIN ST.
SUMMER ST.
TEMPLE ST.
WEST ST.
TREMONT ST.
BOYLSTON ST.
STUART ST.
DOME ST.
KNEELAND ST.
NEW ENG. MED. SCH.
HARVARD ST.
OAK ST.
WASHINGTON ST.
HARRISON ST.
ALBANY ST.

To Mystic Riv. Toll Bridge
U.S. Naval Reservation
BATTERY WHARF
SUMMER TUNNEL (TOLL)
LINCOLN WHARF
UNION WHARF
SARGENTS WHARF
LEWIS WHARF
COMMERCIAL WHARF
T WHARF
LONG WHARF
NEW ENGLAND AQUARIUM
INDIA WHARF
ROWES WHARF
NORTHERN AV. BRIDGE
CHUNNEL
SOUTH STATION
DORCHESTER ST.
SUMMER ST. BRIDGE
PORT POINT
SUMMER ST.

Legend

- City Routes
- One Way Streets
- U. S. and State Routes
- Freedom Trail

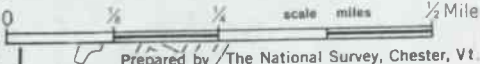

Prepared by The National Survey, Chester, Vt.



SKYWALK VIEW

NORTH

- 1 Harvard Stadium
- 2 Sunapee Mountains (70 miles)
- 3 Harvard Bridge
- 4 William James Center of Behavioral Sciences — Harvard
- 5 New Hampshire Mountains (80 miles)



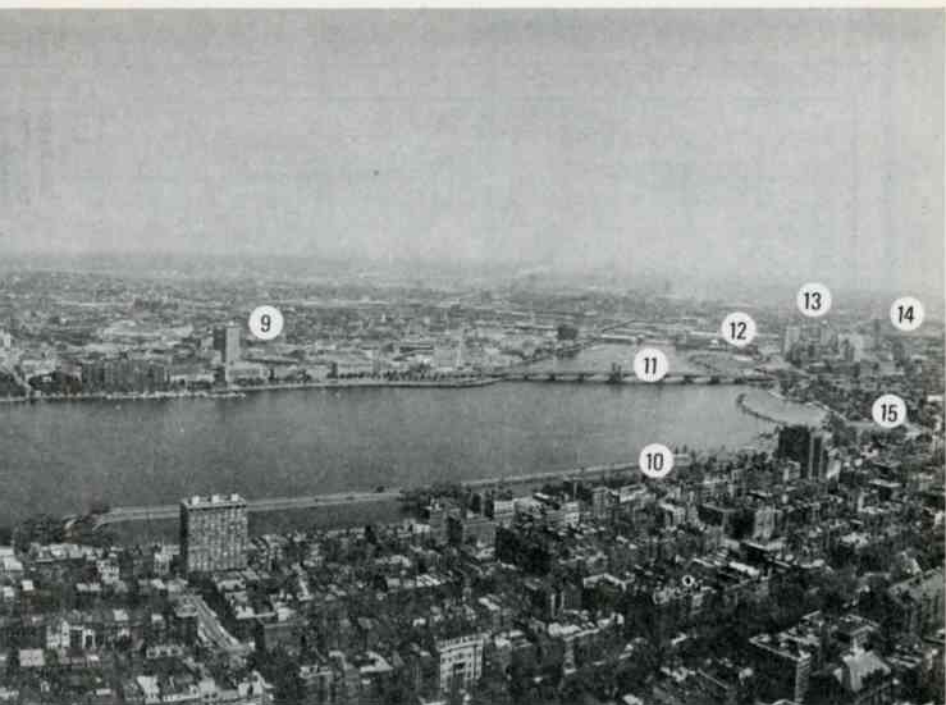

- | | |
|---|---|
| 6 M.I.T. | 11 Longfellow Bridge |
| 7 Charles River Basin | 12 Museum of Science |
| 8 Cecil and Ida Green Building
MIT (Earth Sciences) | 13 Bunker Hill Monument —
Charlestown |
| 9 Site of National Aeronautical
and Space Administration
Research Laboratory | 14 Mystic River Bridge to
northern points |
| 10 Charles River Esplanade | 15 Hatch Memorial Band Shell |





SKYWALK VIEW

From the 50th floor of the 750 foot Prudential Tower; an unparalleled view of Boston and the surrounding area. Through this panorama is woven a storied history which makes Boston unique among all the cities of the world.

SOUTH

- | | | |
|--|------------------------------------|-----------------------------------|
| 1 Long Island Hospital | 5 Columbia Point Housing Project | 9 Union Methodist Church |
| 2 Minot's Light (17 Miles) | 6 Southeast Expressway to Cape Cod | 10 Blue Hills |
| 3 Dorchester Heights, Telegraph Hill | 7 Boston University Medical Center | 11 Franklin Park and Zoo |
| 4 Cathedral of the Holy Cross (Roman Catholic) | 8 Boston City Hospital | 12 John Eliot Church |
| | | 13 Boston Arena |
| | | 14 Penn-Central R.R. line to N.Y. |
| | | 15 Fort Hill |

Here's your guide . . .

to the most exciting shopping excursion you can have in Boston.

Prudential Center has all you need to make a fun-filled day or evening, from eight smart new restaurants to six elegant lounges, 42 shops, and convenient underground parking that's never more than an escalator ride from the fun.

To top off your visit to Pru Shopping Plaza, step into the Tower's lobby and take an elevator ride to the Skywalk, the best view in town. From 750 feet above the city, you'll have a dramatic view as far as New Hampshire and Vermont, and a breathtaking look straight down at all of the New Boston spread before you. On the 50th floor, the Skywalk is open daily from 9 a.m. to midnight, Sundays from 1 to 11 p.m. Adults 75 cents, children 25 cents, group rates available by calling 236-3313.



Plaza shops are generally open Wednesday and Friday nights till 9.

Prudential Center is . . .

a unified business, civic, shopping and residential complex covering 31 acres in the heart of Boston's Back Bay. The 52-story *Prudential Tower* is the focal point of the Center and the city. The tower is headquarters for the Northeastern Home Office of the Prudential Insurance Company of America, and more than 60 other leading Boston business firms.

Surrounding Prudential tower is the beautifully landscaped five-acre *Prudential Shopping Plaza*, which includes more than 55 specialty shops, restaurants and banks all shown on the map on the right. To add interest to your stroll on the Plaza three major works of art have been commissioned for Prudential Center. On Boylston Street's North Plaza stands Donald DeLue's "Quest Eternal," a massive five-ton bronze figure of a man reaching for the stars. Crowning the South Plaza's ice rink is Jan Peter Stern's modernistic "Limits of Horizon," a sculpture in stainless steel. In Pru Tower's lobby hangs Alfred M. Duca's "Boston Tapestry," five tons of delicately wrought iron, Sandwich glass and lighting effects combined into the artist's impressions of Boston's rich heritage.

All of elegance is the *Sheraton-Boston Hotel*. 29 stories tall, 1,000 rooms operated by the Boston-based Sheraton Corporation of America. The Hotel has 23 function rooms, four major restaurants and four cocktail lounges. You'll also enjoy the beautiful swimming pool, the garden terrace, and all the features of the luxurious Sheraton-Boston.

Opera and major national conventions share the *City of Boston War Memorial Auditorium*, 150,000 square feet of modern exhibition and performance facility adjoining the Sheraton-Boston and Pru Tower. The main hall seats 5,800 for theatrical performances that have included the Metropolitan Opera, and the building's three



floors offer convention managers and guests the utmost in physical facilities.

Granite groves and red-brick 26-story towers identify the *Prudential Center Apartments*, three of the best buildings to call home in the heart of Boston's most exciting location. Round the clock attention is lavished on residents who experience all the finest of intown living. Next to the apartments is *Lord & Taylor's* two-level specialty store.

Construction to complete the Center includes a 25-story office tower and Boston's First Sak's Fifth Avenue Shop.

Getting to Prudential Center is easy, by Mass. Turnpike exit directly to Center Garages built for 3,000 cars, or by MBTA, with stations at Copley, Auditorium and Prudential. Two major railroads carry commuters to southern and western points.

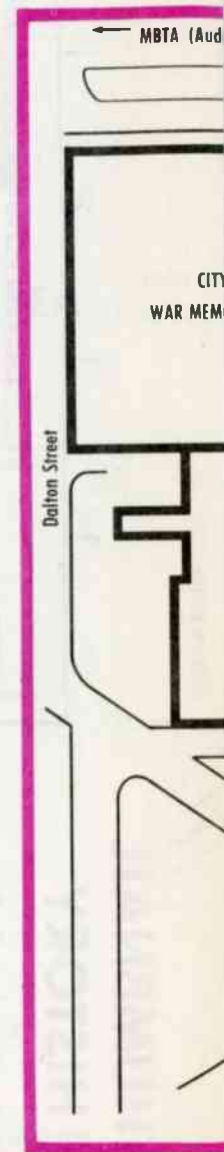

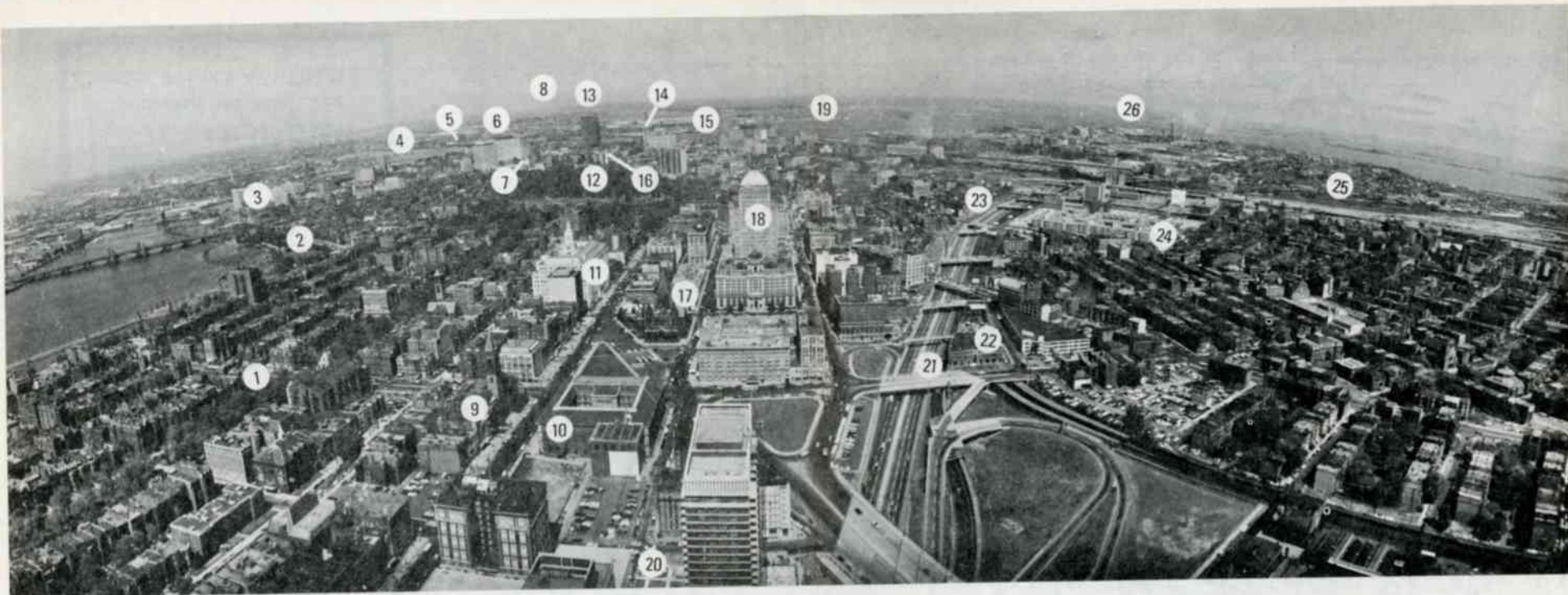

EAST

- | | | | |
|--|--|--|--|
| <p>1 Commonwealth Avenue, Back Bay</p> <p>2 Hatch Memorial Shell</p> <p>3 Mass. General Hospital and Charles River Park</p> <p>4 Boston Navy Yard</p> <p>5 Old North Church</p> <p>6 Government Center</p> <p>7 State House and Beacon Hill</p> | <p>8 Eastern Point, Gloucester (28 Miles)</p> <p>9 Old South Church</p> <p>10 Boston Public Library</p> <p>11 New England Life Building</p> <p>12 Boston Common</p> <p>13 New England Merchants National Bank Building</p> <p>14 Custom House Tower</p> | <p>15 State Street Bank Building</p> <p>16 Park Street Church</p> <p>17 Trinity Church, Copley Square</p> <p>18 John Hancock Building</p> <p>19 Logan International Airport</p> <p>20 Prudential Center Apartments</p> | <p>21 Mass. Turnpike (East)</p> <p>22 Back Bay RR Station</p> <p>23 Tufts-New England Medical Center</p> <p>24 Castle Square Housing Project</p> <p>25 South Boston</p> <p>26 Boston Harbor Light (10 Miles)</p> |
|--|--|--|--|





WEST

- 1 The First Church of Christ Scientist
- 2 Horticultural Hall
- 3 Symphony Hall
- 4 New England Conservatory of Music
- 5 Jordan Hall
- 6 Boston YMCA
- 7 Northeastern University
- 8 Museum of Fine Arts
- 9 Mission Church, Roxbury
- 10 New England Baptist Hospital
- 11 Harvard Medical School — Children's Hospital Medical Area
- 12 Beth Israel Hospital — Simmons College
- 13 The Fenway
- 14 Boston Conservatory of Music
- 15 Fenway Park (Home of Boston Red Sox)
- 16 Boston University
- 17 Mt. Wachusett (42 miles)
- 18 Mt. Monadnock (63 miles)
- 19 Boston College—Chestnut Hill
- 20 TV transmitters for Channels 2, 4, 5, 7, 44, 56, 38
- 21 Sheraton-Boston Hotel, Prudential Center

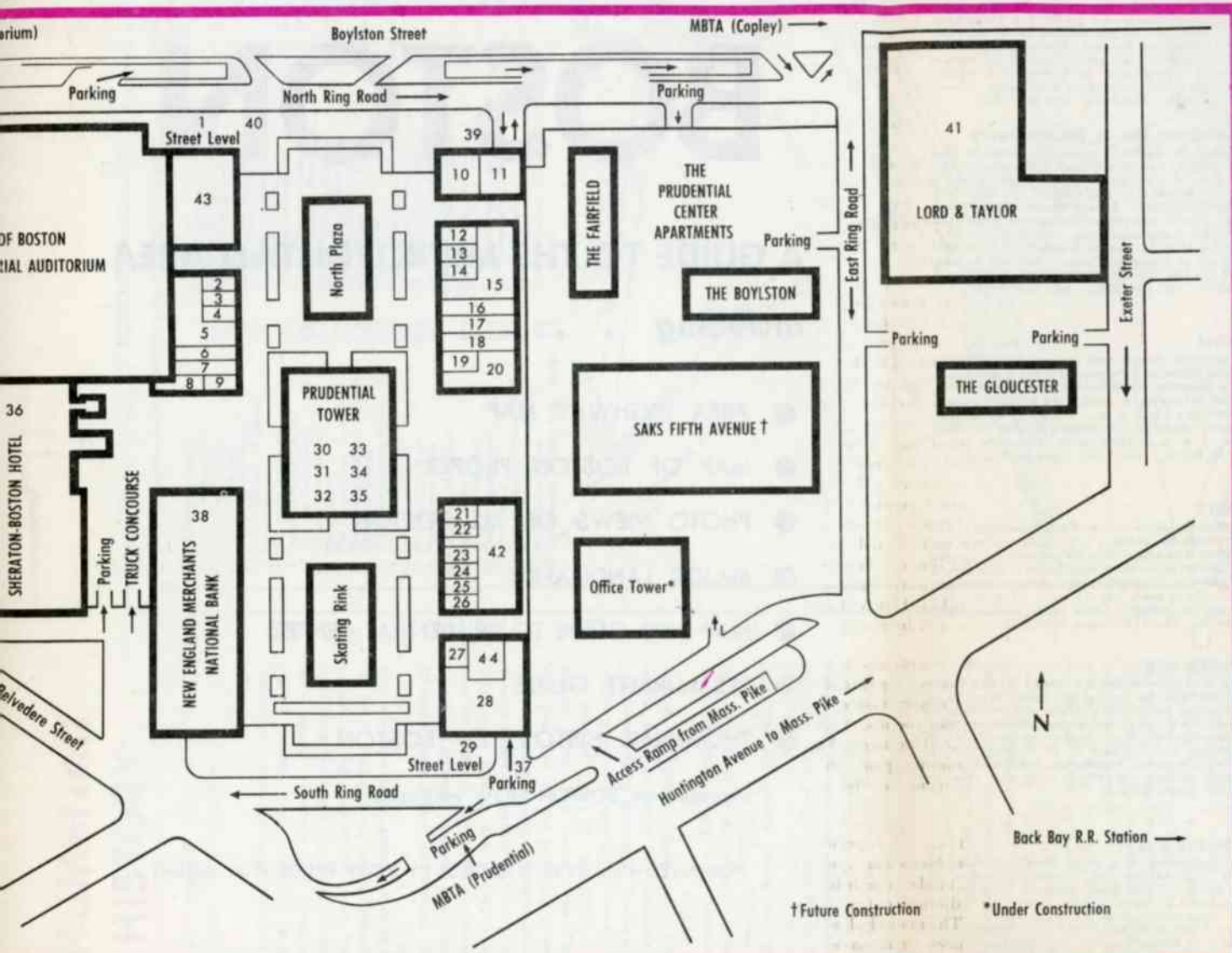

- 1. New England Merchants National Bank (street level)
- 2. Eastern Airlines Travel Center
- 3. Fanny Farmer Candy Shops
- 4. Garber Travel Service
- 5. Roger Kent — Men's Clothing
- 6. Berenson Liquor Mart
- 7. Krey Disc Shop
- 8. Canadian Government Travel Bureau
- 9. Prudential Center Pharmacy
- 10. Sozio Magnavox Showcase
- 11. The Provident Institution for Savings
- 12. Nettleton Shop — Men's Shoes
- 13. Sulgrave, Ltd. — Tobacconist
- 14. Cameras, Ltd.
- 15. Brentano's — Booksellers
- 16. House of Rust Craft — Greeting Cards and Gifts
- 17. Brigham's Ice Cream and Sandwich Shop
- 18. John Douglas — Sportswear
- 19. Hope Chest — Intimate Apparel
- 20. Wilbar's Shoes
- 21. Fanny Farmer Candy Shops
- 22. Bally Shoe
- 23. House of Nine — Women's Petite Apparel
- 24. Sarni Cleaners and Launderers
- 25. Shakuntla — House of India
- 26. Albert's Hosiery
- 27. Boston Globe
- 28. Schrafft's Restaurant
- 29. Edison Appliance Center (street level)
- 30. U. S. Post Office — Lower Lobby
- 31. Ciro Men's Salon — Lower Lobby
- 32. Business Communications, Inc.
- 33. Stouffer's Top of the Hub-Restaurant
- 34. Skywalk — Observation Deck
- 35. Security Office — Lower Lobby
- 36. Sheraton-Boston Hotel
- 37. Drive-up Teller, Merchants Bank
- 38. New England Merchants National Bank
- 39. Star Market (street level)
- 40. Beauty Hour
Le Colifichet } (street level)
Salon Versailles }
- 41. Lord & Taylor
- 42. Wallachs — Men's Clothing
- 43. Paine, Webber, Jackson & Curtis Stockbrokers
- 44. Saint Francis Chapel

FOOD

By the editorial staff of
BOSTON NOW magazine



BORASCHI'S

A delightful blending of Italy and New England in a new restaurant that features the cuisine of both of the areas mentioned. Moderate prices and modern decor in dining areas and cocktail lounge. The ornate red, black and gold color scheme provides a fitting setting for the memorable cuisine. Open from 11:30 a. m. to 11 p. m. daily. Sat. - Sun. 4:30 - midnight. Lounge open till 2 a. m. 793 Boylston St., 536-6300. (see MAP E-3)

BOSTON 1800

BOSTON "1800" brings back the era of gracious dining . . . sumptuous food . . . in a nautical setting, a fabulous harbor view. Surround yourself with nautical antiques . . . brass ship lanterns, figureheads, ship wheels, compasses, anchors. Schooner Wharf Village of Shoppes delights all. Three-quarter scale replica of "FLYING CLOUD" berthed along-side BOSTON "1800". Open daily 12 A. M. to 1 A. M. — Sundays 12 A. M. to 9:00 P. M. Dancing every evening in the Boathouse Lounge. 25 Lewis St., East Boston. 569-1800.

CAFE BUDAPEST

The most famous Boston Hungarian restaurant. Try the "taste of old Hungary" dinner for two — a platter of flaming, savory meats. Prices make Cafe Budapest a "special occasion," but the food is worth it. Open noon - 10:30 p. m. Sat. to midnight. Gypsy Lounge open 5 p. m. - 1 a. m. for cocktails and crepe flambe. 47 Huntington Ave. at Exeter St. (Copley Square Hotel). 734-3388. (see MAP E-4)

DU BARRY

Provincial France, with all the quiet charm that implies, is the inspiration of DuBarry restaurant. Long a Boston institution. Prices are moderate. Wine list is extensive. Excellent service makes dining even more pleasurable. Open for lunch and dinner. Closes at 9 p. m. Saturday. Open Sunday 5 - 9 p. m. 159 Newbury Street, Boston. 262-2445. (see MAP D-4)

FALSTAFF ROOM

Henry VIII should have had it so good. Thick cuts of roast beef, sizzling steaks, and tankards of ale in an English setting on the Second Floor at the Sheraton-Boston Hotel. Open for Breakfast, Lunch and Dinner. 236-2000 (see MAP E-3)

FIVE CHATEAUX

The HOTEL SONESTA—CAMBRIDGE, 120 air-conditioned rooms near Museum of Science just over the River Charles from Downtown Boston. Rooms and restaurant have a splendid view. The FIVE CHATEAUX RESTAURANT features Continental cuisine; prime ribs and baked lobster vitre. One of Boston's finest restaurants. Lunch and dinner weekdays, dinner only Sat., Sun. 1 - 10 p. m. Function and meeting rooms, swimming pool, free parking. 8 minutes from Airport and 5 minutes from Boston. 5 Cambridge Parkway (617) 491-3600. (see MAP B-4)

IGO'S

The gourmet's choice for dinners of roast beef, steak and seafood served in generous portions at two locations in Cambridge (minutes from Harvard Square) and Waltham. Friendly atmosphere and excellent service at moderate prices. Cocktail lounge and bar. Open for lunch and dinner. In Cambridge, 1812 Mass. Ave. 71-3733. In Waltham, 582 Main St. 899-3440. All major charge cards honored at both locations.

KON TIKI PORTS

A delightful Polynesian oasis in the Sheraton-Boston Hotel, created and supervised by Stephen Crane Associates. At noon . . . all you can eat for \$2.50, amid the exotic settings of Bangkok, Papeete, Saigon and Macao. At night . . . a luxurious feast of Far Eastern and American specialties or an intimate late supper. Choose from tropical or standard beverages. (Closed Sundays for lunch). 262-3063 (see MAP E-3)

OLDE LONDON PUB & DELMONICO'S

Authentic 16th Century reconstruction shipped from England. Hearty sandwiches, beef, daily specials from \$1.75. Mugs of brew, instant service. Next to Lord & Taylors. DELMONICO'S RESTAURANT & DIAMOND JIM'S PIANO LOUNGE. Superb dinners. Turn of Century decor. Snails and Lobster, Shrimp and prime beef, provide unique Boston experience. Weekdays 5 - 10 P. M., Saturday 11 P. M., Sunday Brunch 9 - 3 P. M. 60. Exeter Street at Prudential Center. Adjacent Parking. ALL PART OF THE LENOX HOTEL'S OLD WORLD OF HOSPITALITY. Tel. 536-5300. (see MAP E-4)

OMONIOIA

For a generous Greek meal in classic Greek setting try Omonioia Restaurant. Home style food includes shrimp saute a la Omonioia, shishkebabs, stuffed grape leaves. Live Greek entertainment each night except Tuesday. Open every day 11:30 a. m. - 1 a. m. New Aegean dining room. Reduced rate parking behind the Music Hall after 5 p. m. Credit cards. Moderate prices. 42 Stuart St., Boston. 482-1349. (see MAP D-6)

POLCARI'S

Internationally known, Polcari's is remodelled with many international objets d'art. Fresh seafood and other Italian delicacies justify its reputation. Located at North Station in the North End (Boston's "Little Italy"). Generous drinks. Cocktail Lounge adjoins restaurant. A "must." Open every day 11 a. m. - 1 a. m. July and August to midnight. Free valet parking. 283 Causeway St. 742-4142. (see MAP B-7)

RED COACH GRILL

Enjoy a taste of yesteryear's Boston at The Red Coach Grill, a hospitable inn serving such classic favorites as charcoal-broiled sirloin, Maine Lobster and prime ribs of Roast Beef. The charm of red leather, oak beams, brick fireplaces and polished brass surrounds the finest food and drink. There's a Red Coach at 43 Stanhope Street, Boston, and in Braintree, Framingham, Hingham, Hyannis, Middleboro, Saugus, Wayland and soon, Newton. 266-1900. (see MAP E-4)

TOP OF THE HUB

Instant Sightseeing — a fringe benefit of dining at Stouffer's "Top of the Hub." Spectacular view of Greater Boston. Dinner Menu a unique experience — from appetizers to drinks. It's no wonder the "Top of the Hub" is the restaurant all Boston looks up to. Open 7 days — 11:00 A. M. to 12:00 P. M. Weekdays — Until 1:00 A. M. Friday, Saturday. Sunday Brunch 11:00 A. M. to 2:30 P. M. Dinner 4:00 P. M. to 9:00 P. M. Entertainment evenings except Sunday. A: Pru Center. 536-1775. (see MAP E-3)